

This Site Plan 4 Rev B replaces Site Plan 4 by modification by the Secretary of State for Transport upon confirmation of the Order by him

SITE PLAN 4

REV B

CJM

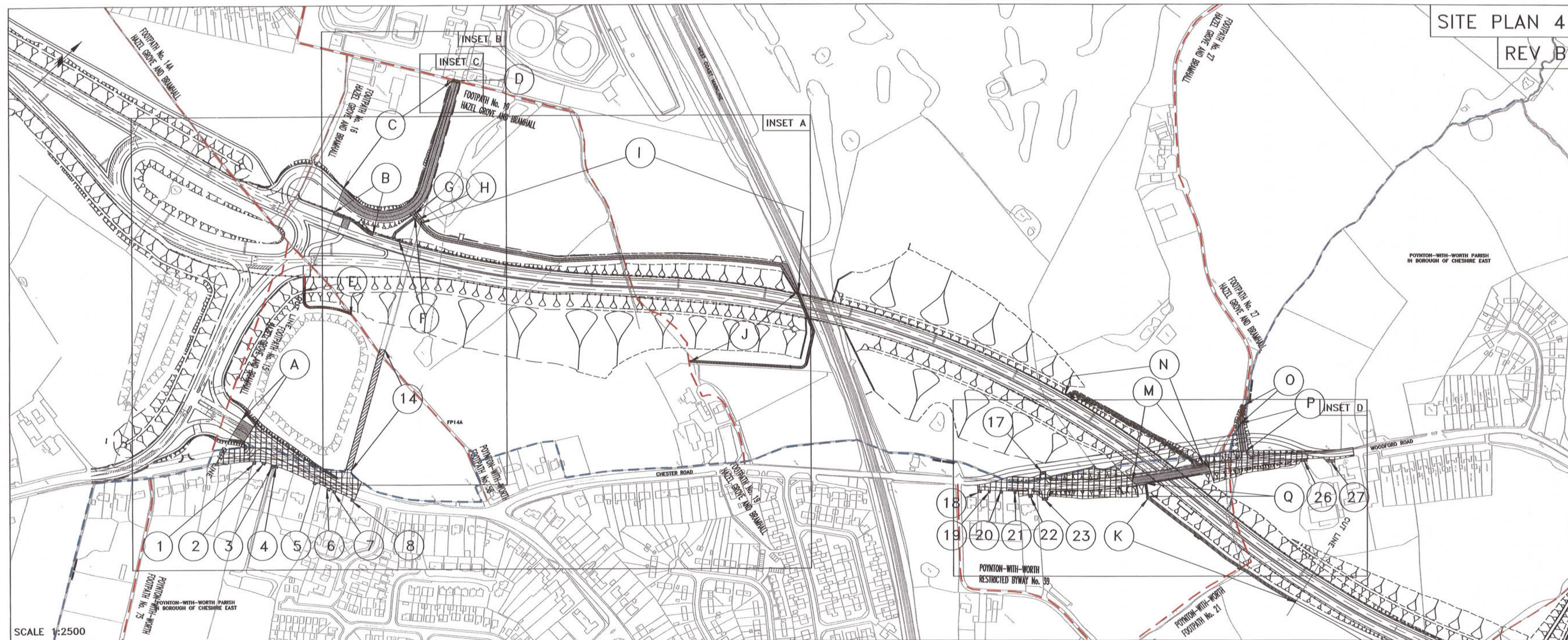

SCALE 1:2500

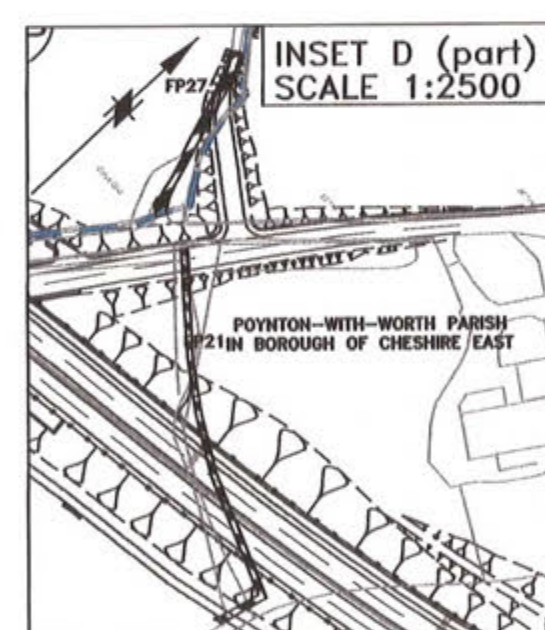

INSET A SCALE 1:2500

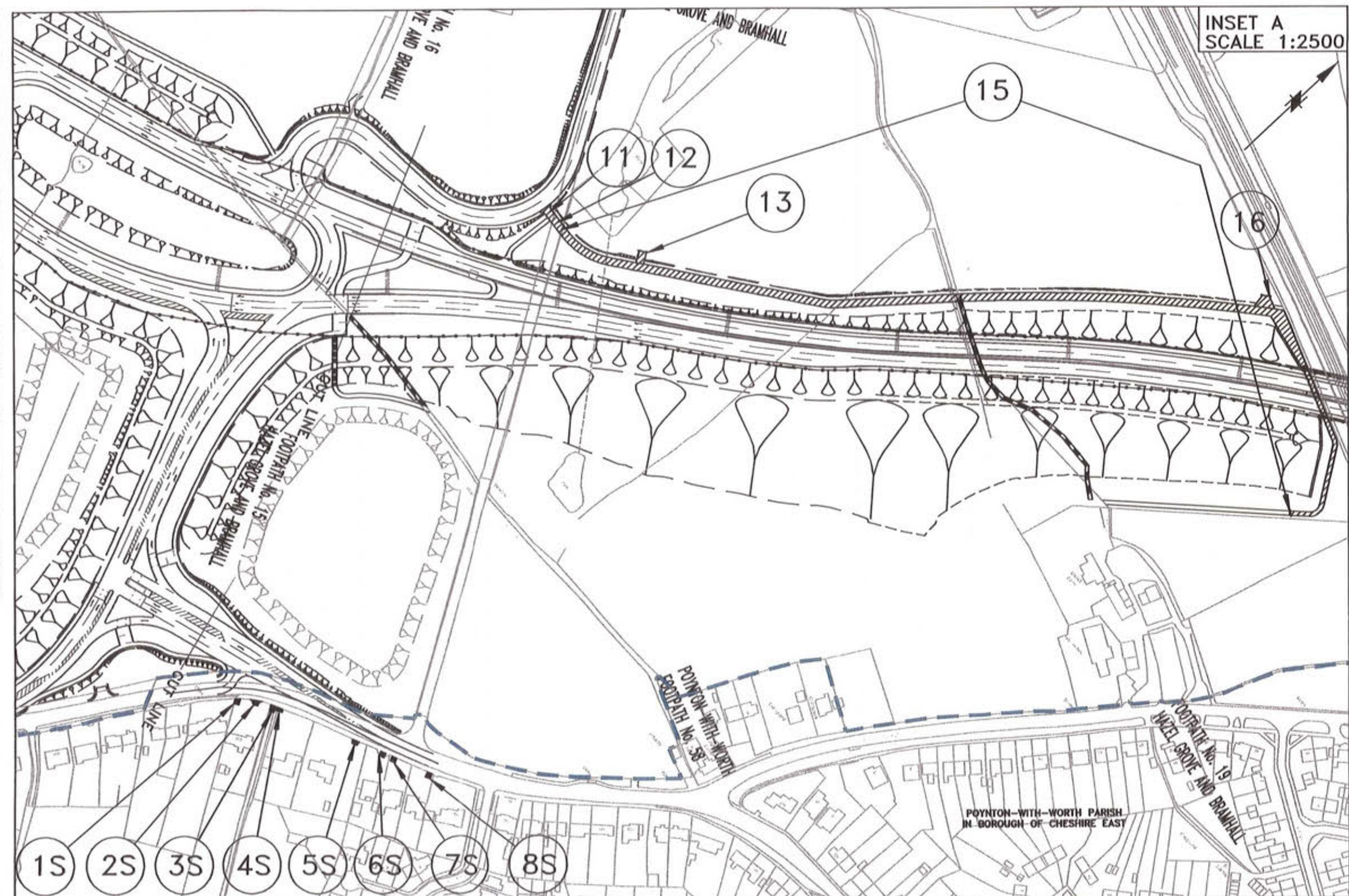

INSET B SCALE 1:2500

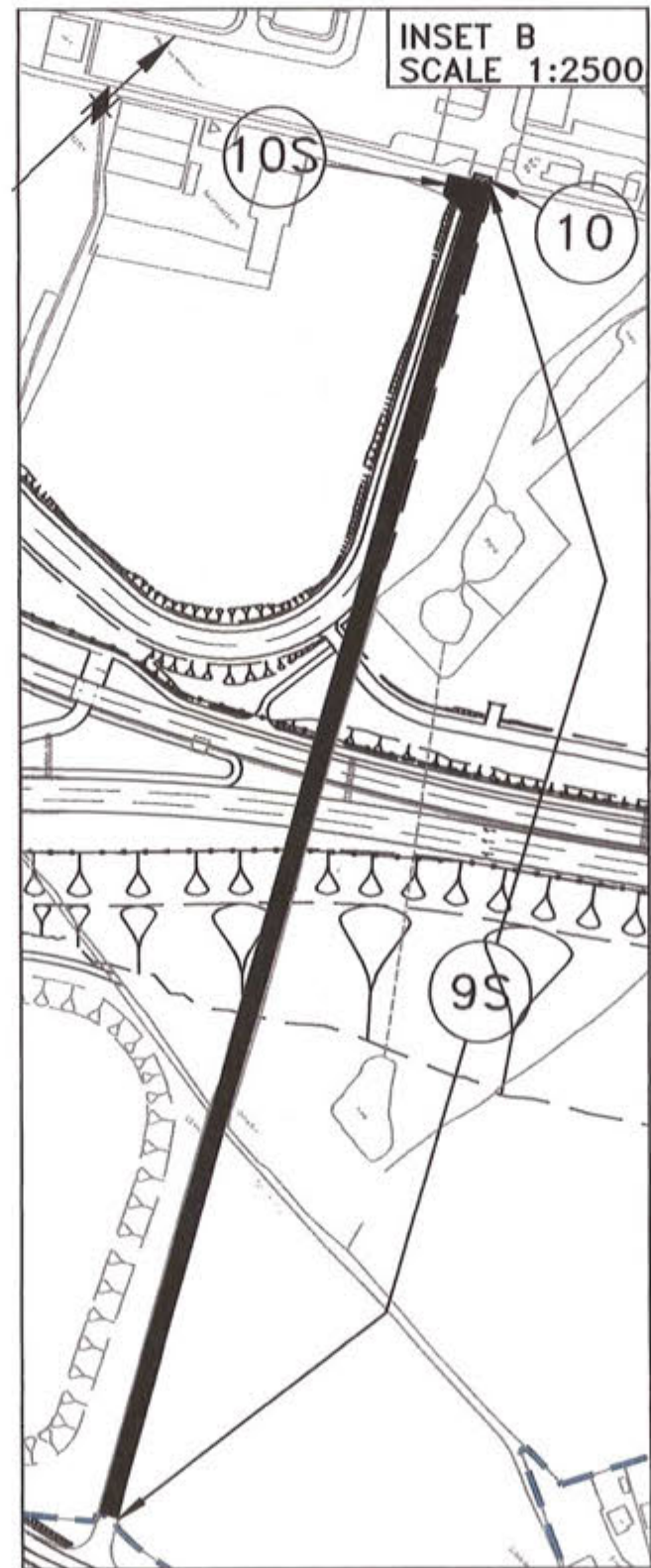

NOTE
ALONG THIS ROUTE LABELLED 'K' A NEW PRIVATE MEANS OF ACCESS LABELLED '28' (WHICH WILL BE SUBJECT TO VEHICULAR RIGHTS) IS TO BE PROVIDED AND SUBJECT THERETO, THE FOOTPATH LABELLED 'K' IS TO BE PROVIDED.

NOTE
ALONG THIS ROUTE LABELLED 'D' A NEW PRIVATE MEANS OF ACCESS LABELLED '10' (WHICH WILL BE SUBJECT TO VEHICULAR RIGHTS) IS TO BE PROVIDED AND SUBJECT THERETO, THE FOOTPATH LABELLED 'H' IS TO BE PROVIDED.

NOTE
ALONG THIS ROUTE LABELLED 'G' A NEW PRIVATE MEANS OF ACCESS LABELLED '11' (WHICH WILL BE SUBJECT TO VEHICULAR RIGHTS) IS TO BE PROVIDED AND SUBJECT THERETO, THE FOOTPATH LABELLED 'G' IS TO BE PROVIDED.

NOTE
ALONG THIS ROUTE LABELLED 'H' A NEW PRIVATE MEANS OF ACCESS LABELLED '12' (WHICH WILL BE SUBJECT TO VEHICULAR RIGHTS) IS TO BE PROVIDED AND SUBJECT THERETO, THE FOOTPATH LABELLED 'H' IS TO BE PROVIDED.

NOTE
ALONG THIS ROUTE LABELLED 'I' A NEW PRIVATE MEANS OF ACCESS LABELLED '15' (WHICH WILL BE SUBJECT TO VEHICULAR RIGHTS) IS TO BE PROVIDED AND SUBJECT THERETO, THE FOOTPATH LABELLED 'I' IS TO BE PROVIDED.

NOTE
ALONG THIS ROUTE LABELLED 'J' A NEW PRIVATE MEANS OF ACCESS LABELLED '15' (WHICH WILL BE SUBJECT TO VEHICULAR RIGHTS) IS TO BE PROVIDED AND SUBJECT THERETO, THE FOOTPATH LABELLED 'J' IS TO BE PROVIDED.

NOTE
ALONG THIS ROUTE LABELLED 'O' A NEW PRIVATE MEANS OF ACCESS LABELLED '24' (WHICH WILL BE SUBJECT TO VEHICULAR RIGHTS) IS TO BE PROVIDED AND SUBJECT THERETO, THE FOOTPATH LABELLED 'O' IS TO BE PROVIDED.

NOTE
ALONG THIS ROUTE LABELLED 'P' A NEW PRIVATE MEANS OF ACCESS LABELLED '25' (WHICH WILL BE SUBJECT TO VEHICULAR RIGHTS) IS TO BE PROVIDED AND SUBJECT THERETO, THE FOOTPATH LABELLED 'P' IS TO BE PROVIDED.

This map is reproduced from Ordnance Survey material with the permission of Ordnance Survey on behalf of the Controller of Her Majesty's Stationery Office © Crown copyright. Unauthorised reproduction infringes Crown copyright and may lead to prosecution or civil proceedings. Stockport Metropolitan Borough Council 100019571 2010

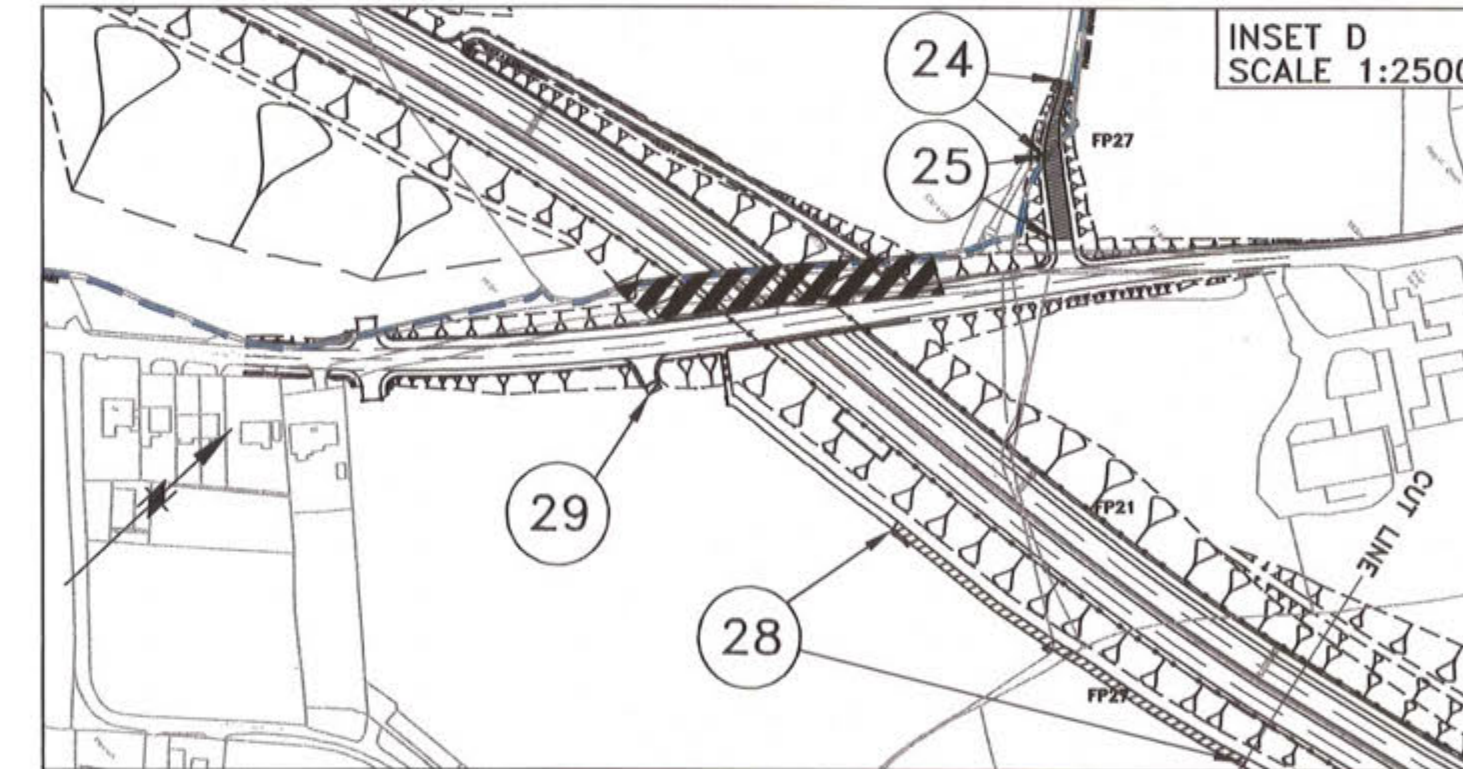

INSET D SCALE 1:2500

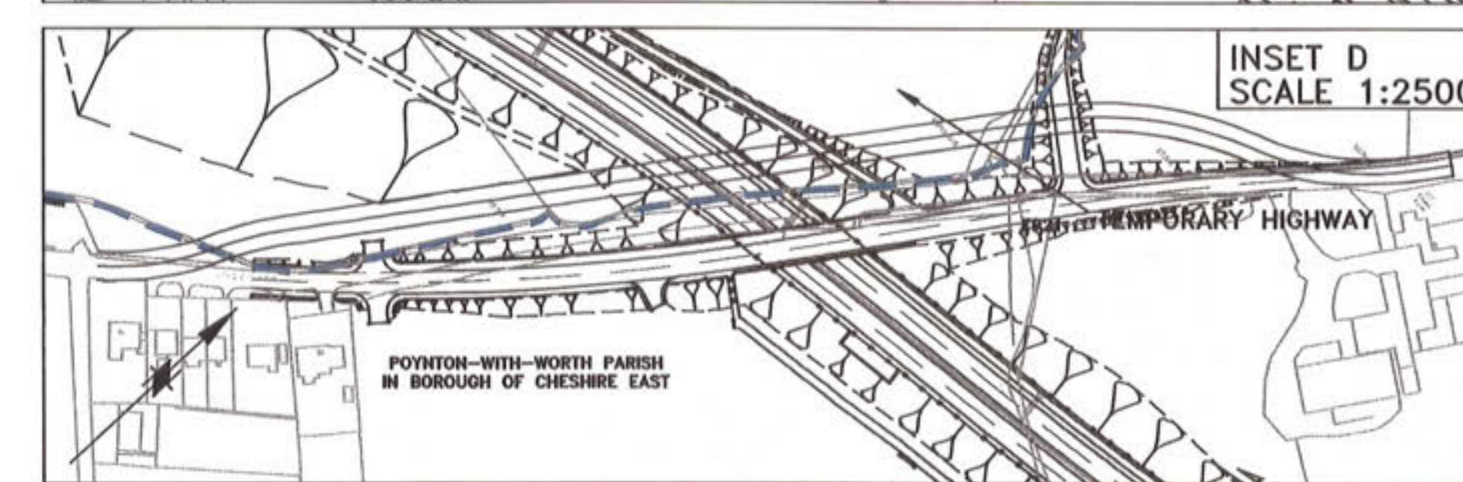

INSET D SCALE 1:2500

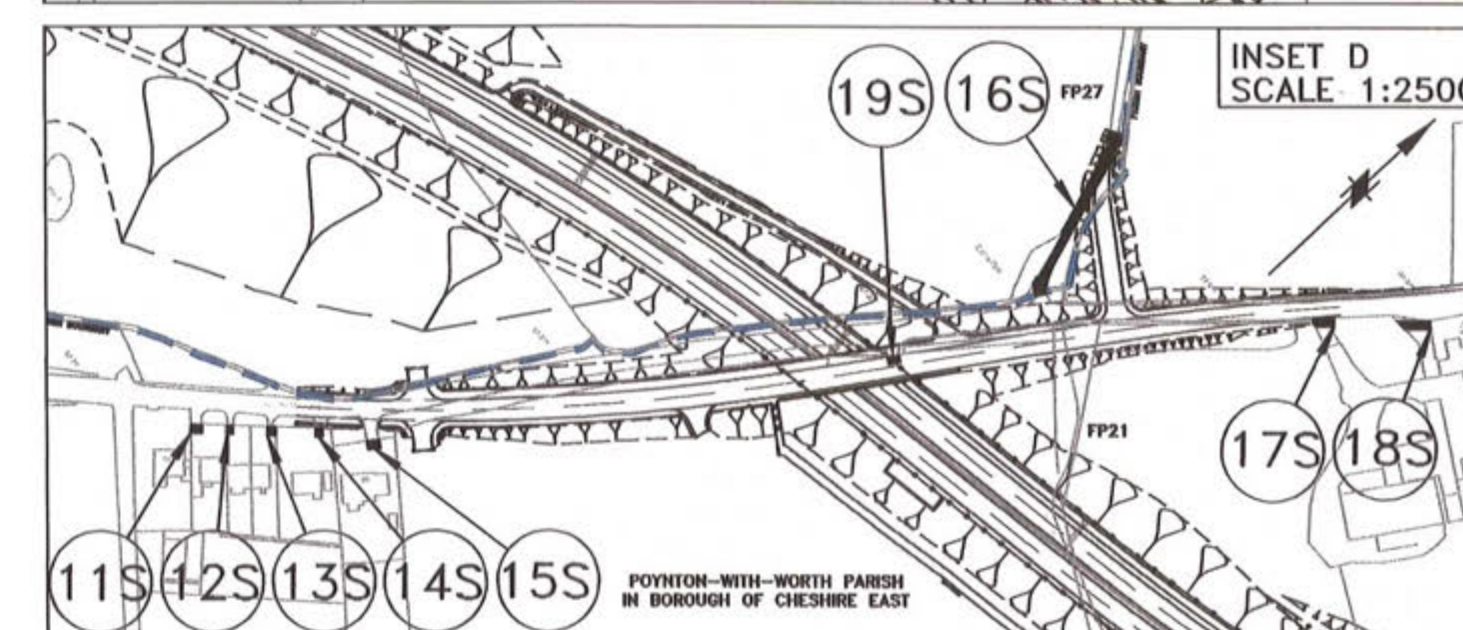

INSET D SCALE 1:2500

WOODFORD ROAD, FOOTPATHS FP14A, FP16, FP19, FP21 & FP27 AND OTHER ALTERATIONS

THE METROPOLITAN BOROUGH OF STOCKPORT (HAZEL GROVE (A6) TO MANCHESTER AIRPORT A555 CLASSIFIED ROAD) SIDE ROADS ORDER 2013

