

This Site Plan 8 Rev A replaces Site Plan 8 by modification by the Secretary of State for Transport upon confirmation of the Order by him

CJM

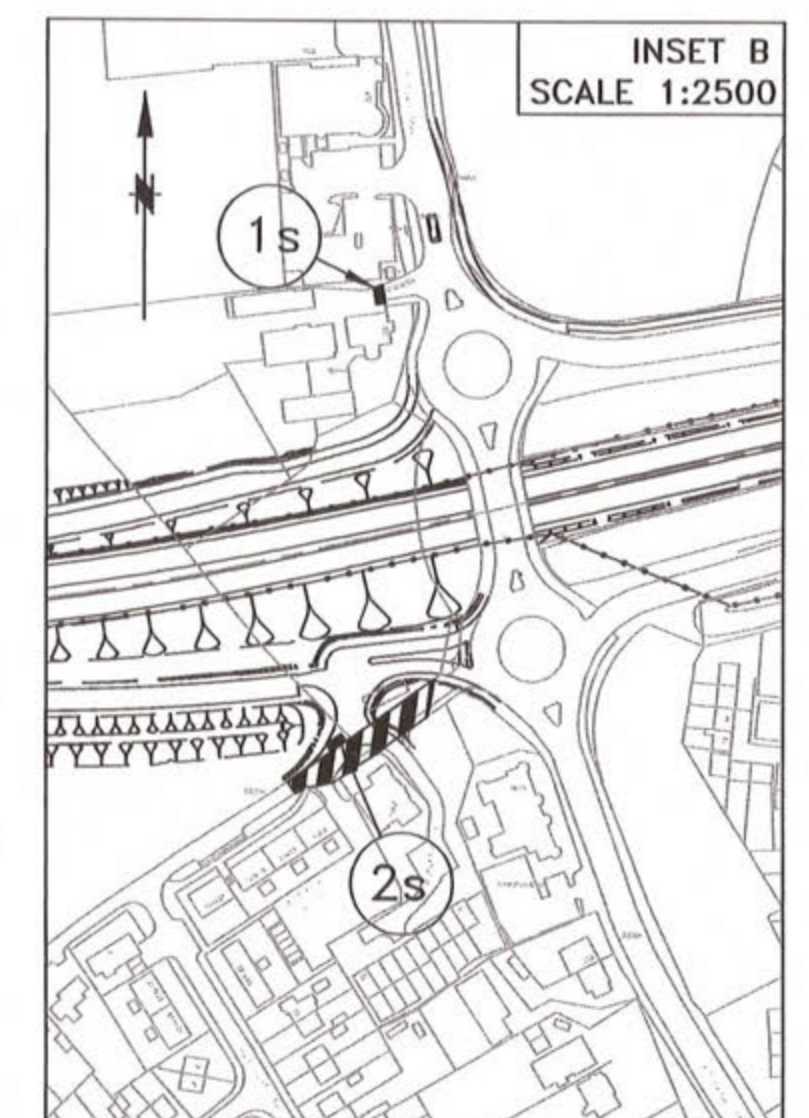
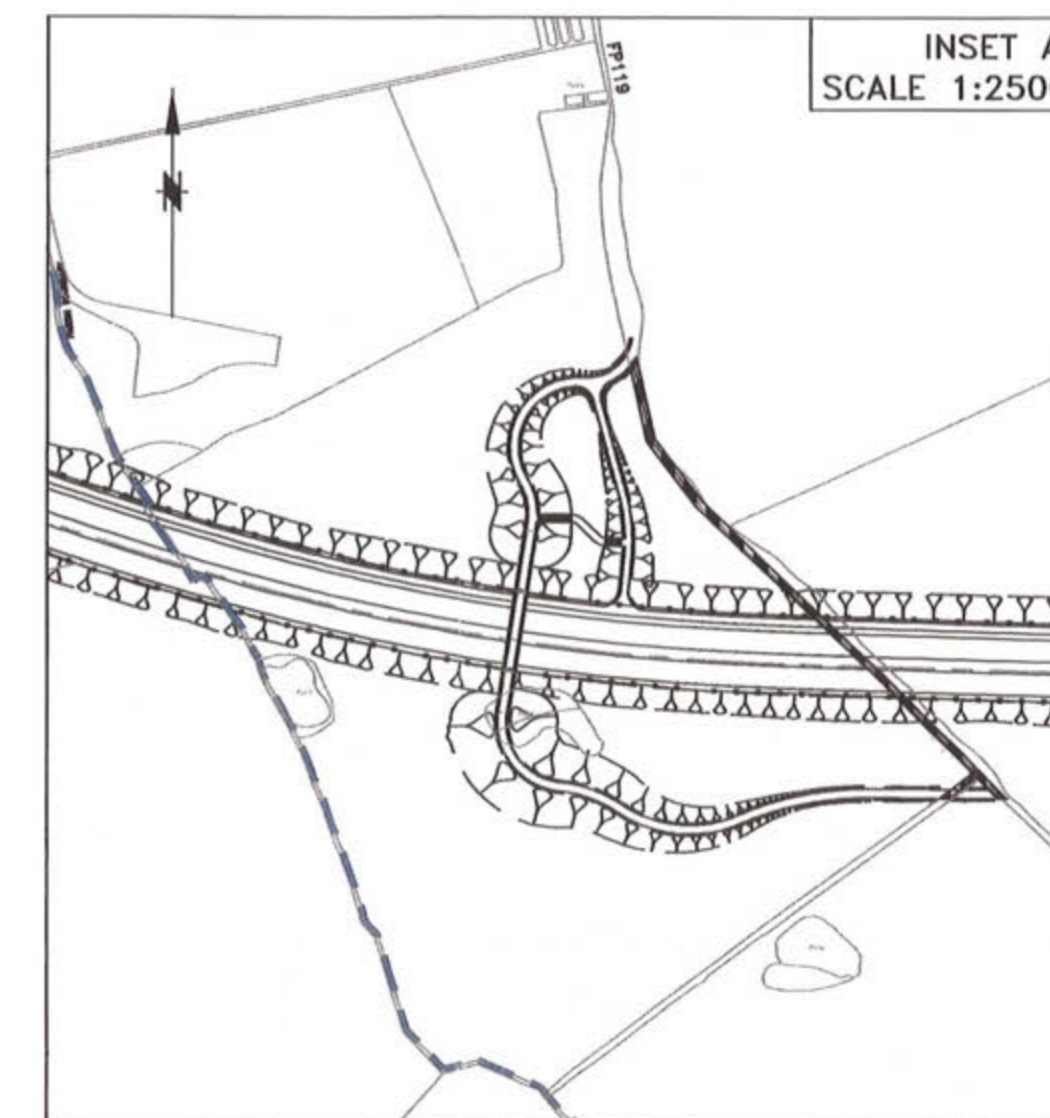
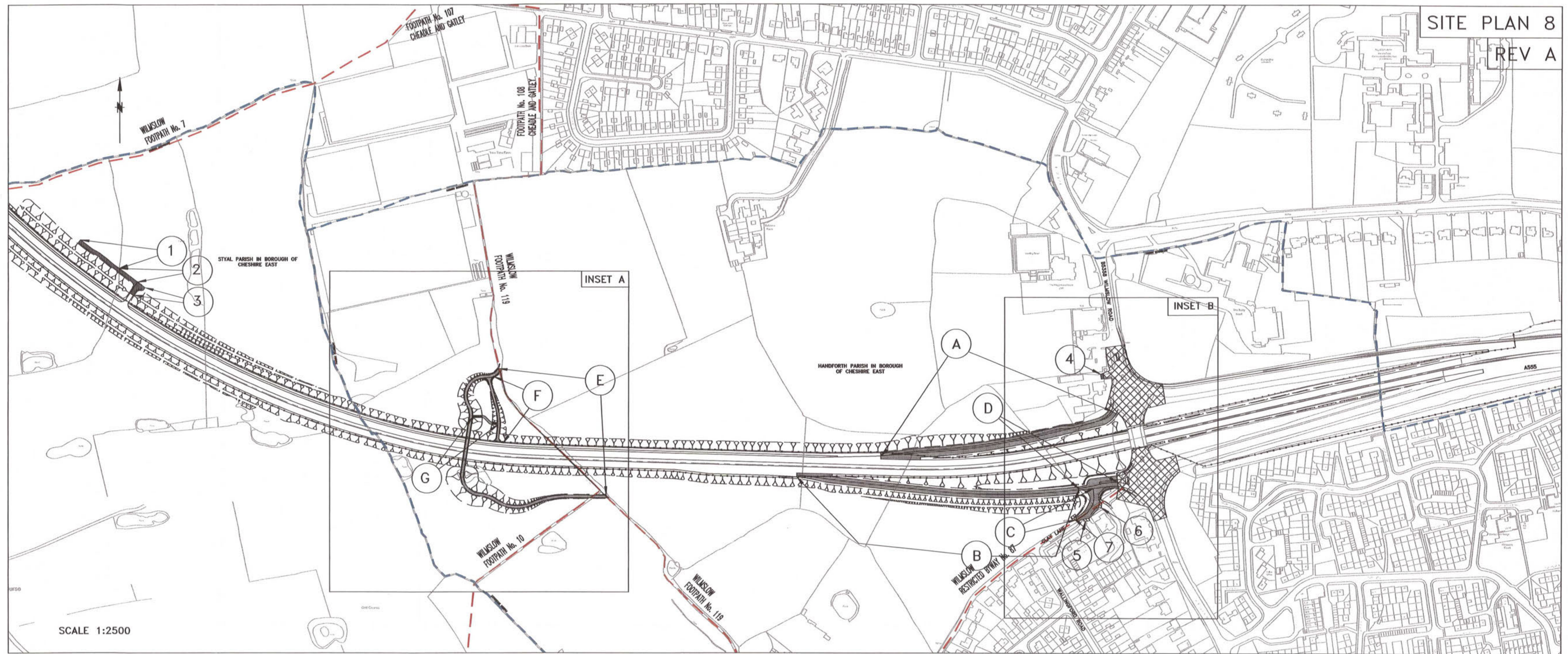

A555, B5358 WILMSLOW RD, CLAY LANE, FOOTPATHS FP10, FP119, RB87 AND OTHER ALTERATIONS
 THE METROPOLITAN BOROUGH OF STOCKPORT (HAZEL GROVE (A6)
 TO MANCHESTER AIRPORT A555 CLASSIFIED ROAD) SIDE ROADS ORDER 2013

This map is reproduced from Ordnance Survey material with the permission of Ordnance Survey on behalf of the Controller of Her Majesty's Stationery Office © Crown copyright. Unauthorised reproduction infringes Crown copyright and may lead to prosecution or civil proceedings. Stockport Metropolitan Borough Council 100019571 2010

