

This map is reproduced from Ordnance Survey material with the permission of Ordnance Survey on behalf of the Controller of Her Majesty's Stationery Office. © Crown copyright. Unauthorised reproduction infringes Crown copyright and may lead to prosecution or civil proceedings. Stockport Metropolitan Borough Council 100019571 2012

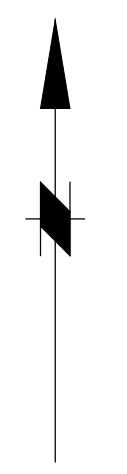

KEY

Lighting Column Locations

160m Desirable Stopping Sight Distance

Directions Sign Locations

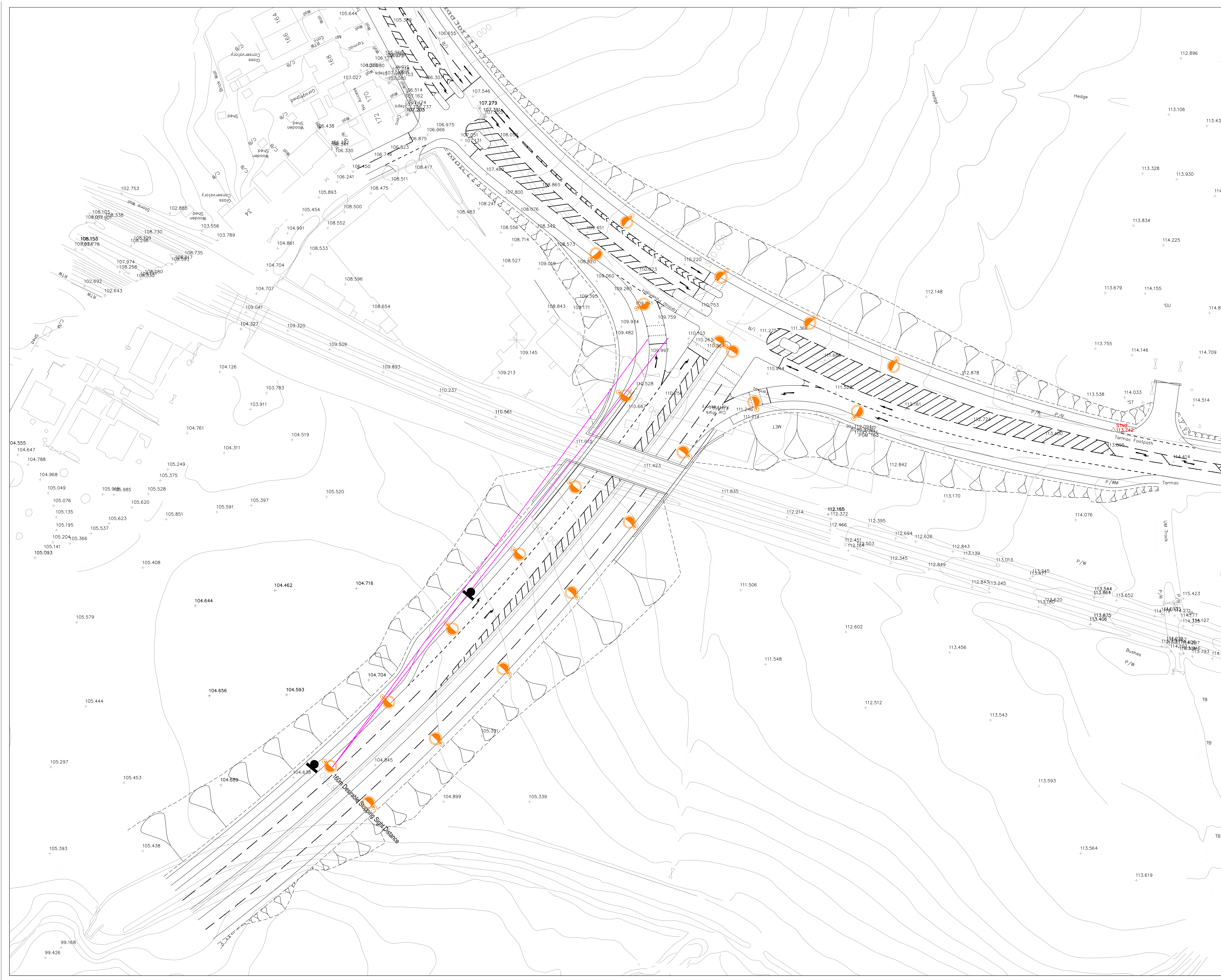

Rev.	Drawn	Checked	Date	Revision Details
TB				

[www.semmms.info](http://www.semmms.info)

STOFFORD HOUSE  
STOCKPORT SK9 3JF  
TEL : 0161 474 4351  
FAX : 0161 474 4833

Job Title  
**A6 to MANCHESTER AIRPORT RELIEF ROAD**

Drawing Title  
**ALTERNATIVE A6 BUXTON ROAD JUNCTION (ONLINE)**

Drawn	Engineer	Checked	Approved
SEB	NH		
Date 2/06/14	Date 2/06/14	Date	Date
Size A1	Scale 1:500		
SCG No.	Filename		

Drawing No. 1007/3D/DF7/A6-MA/GA/316 Revision