

This drawing has been prepared for the use of AECOM's client. It may not be used, modified, reproduced or relied upon by third parties, except as agreed by AECOM's client or as required by law. AECOM's client accepts no responsibility, and AECOM's client releases AECOM from any liability for any loss or damage, including consequential loss or damage, arising from the use of this drawing without AECOM's written consent. To view the full disclaimer, please refer to the AECOM's Client Acceptance Form available on the AECOM's website.

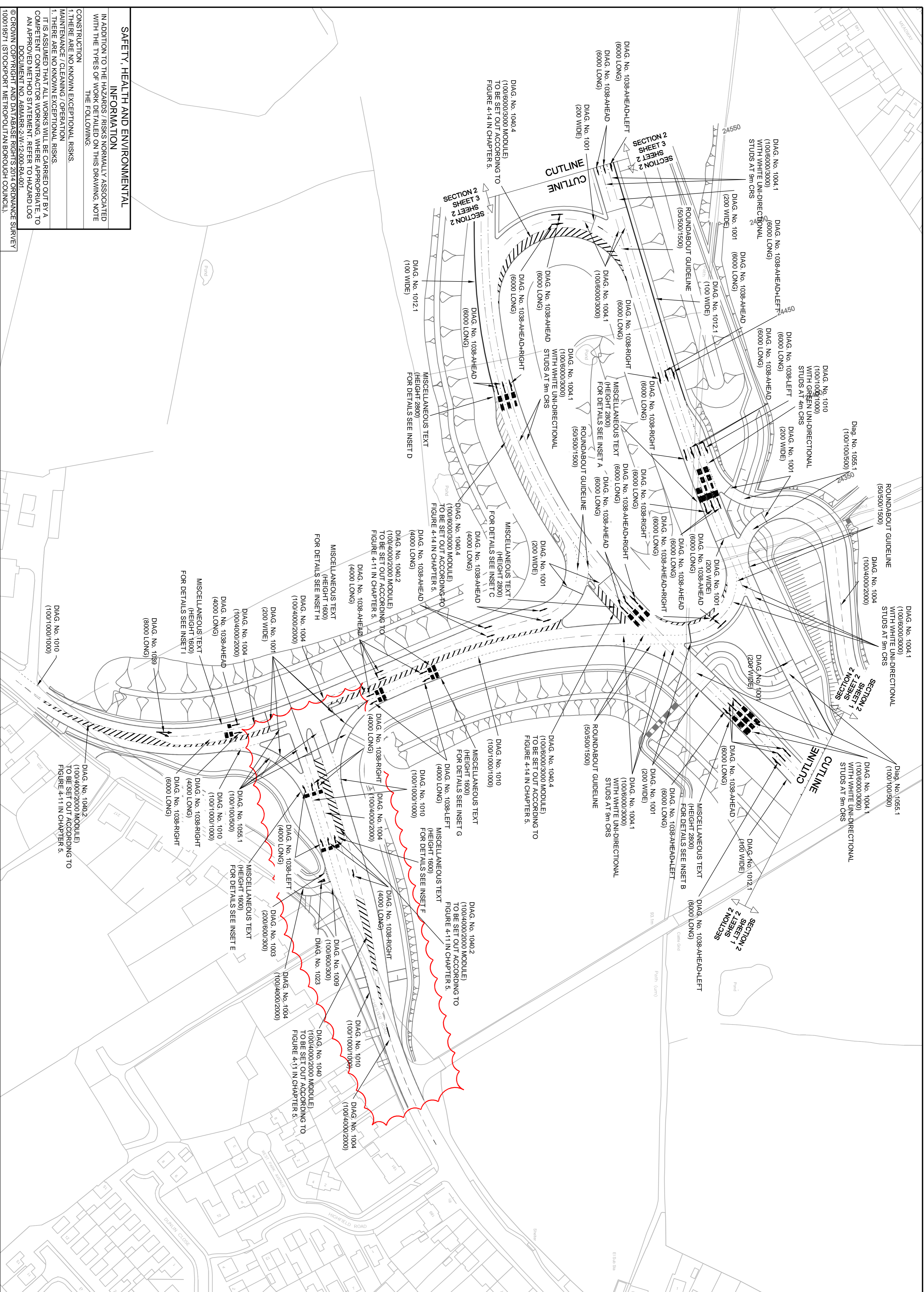

NOTES CONTINUED

8. FOR DETAILS OF ROAD MARKINGS SPECIFICATIONS REFER TO ROAD MARKINGS SPECIFICATION APPENDIX A6MARR-Q-W-004-SP-001.

9. ROAD STUDS - MAINLINE (A555) NEARSIDE EDGE OF CARRIAGEWAY; WHITE COLOURED UNIDIRECTIONAL STUDS TO BE AT 18m CENTRES PLACED IN THE GAPS BETWEEN PARTS OF MARKING TO DIAGRAM 1005.1

OFFSIDE EDGE OF CARRIAGEWAY; AMBER COLOURED BI-DIRECTIONAL STUDS AT 18m CENTRES TO BE PLACED AT THE SIDE OF AND ADJACENT TO MARKING TO DIAGRAM 1003.2

DIAGRAM 1003.2 UNIDIRECTIONAL STUDS TO BE AT 9m CENTRES PLACED IN THE GAPS BETWEEN PARTS OF MARKING TO DIAGRAM 1004.1

KEY:

WITH (mm)	MARK (mm)	GAP (mm)
XXX / XXX / XXX	XXX / XXX / XXX	XXX / XXX / XXX

SCALE: 1:1000 ON A1; 1:2000 ON A3

INSET A	INSET B	INSET C	INSET D	INSET E	INSET F	INSET G	INSET H

CLIENT: CHESHIRE EAST COUNCIL, STOCKPORT METROPOLITAN BOROUGH COUNCIL, MANCHESTER CITY COUNCIL

PROJECT: A6 TO MANCHESTER AIRPORT RELIEF ROAD

TITLE: ROAD MARKINGS WORK SECTION 2 SHEET 2 OF 4

Drawn:	Checked:	Approved:	Scale:
JE	RT	ACR	1:1000
Date: 04/08/15	Date: 04/08/15	Date: 04/08/15	Original drawing size: 841 x 594 - A1
Drawing No: A6MARR-2-W-12-004-DR-002	Rev: C1		

SAFETY, HEALTH AND ENVIRONMENTAL INFORMATION

IN ADDITION TO THE HAZARDS / RISKS NORMALLY ASSOCIATED WITH THE TYPES OF WORK DETAILED ON THIS DRAWING, NOTE THE FOLLOWING:

- CONSTRUCTION**
1. THERE ARE NO KNOWN EXCEPTIONAL RISKS.
 2. MAINTENANCE / CLEANING / OPERATIONAL RISKS.
 3. IT IS ASSUMED THAT ALL WORKS WILL BE CARRIED OUT BY A COMPETENT CONTRACTOR WORKING, WHERE APPROPRIATE, TO AN APPROVED METHOD STATEMENT. REFER TO HAZARD LOG DOCUMENT NO. A6MARR-2-W-12-000-RA-001
 4. © CROWN COPYRIGHT AND DATA RIGHTS 2014 ORDINANCE SURVEY (100019571) (STOCKPORT METROPOLITAN BOROUGH COUNCIL).

REV.	DATE	AMENDMENT DETAILS	ORIG	CHK'D	ENG	CAT	APP'D
C1	04/08/15	ISSUE FOR CONSTRUCTION	JE	RT			ACR

NOTES

1. ALL ROAD MARKINGS ARE TO BE IN ACCORDANCE WITH TRAFFIC SIGNS MANUAL CHAPTER 5 (ROAD MARKINGS) AND THE TRAFFIC SIGNS REGULATIONS AND GENERAL DIRECTIONS 2002 AND THE TRAFFIC SIGNS (AMENDMENT) (NO2) REGULATIONS AND GENERAL DIRECTIONS 2011.
2. WHERE NEW ROAD MARKINGS ARE TO BE REMOVED AS NECESSARY, THE EXISTING ROAD MARKINGS ARE TO BE REMOVED AS NECESSARY.
3. FOR DETAILS OF CHEVRON MARKINGS SEE HIGHWAY CONSTRUCTION DETAILS DRAWING DA.
4. ROAD STUDS ARE TO BE LAID IN ACCORDANCE WITH HIGHWAY CONSTRUCTION DETAILS (HGD) SERIES 'D' DRAWINGS D1 TO D6 WHERE APPROPRIATE. ALL ROAD STUDS ARE TO BE SPACED IN ACCORDANCE WITH PARAGRAPH 6.12 OF CHAPTER 5 OF THE TRAFFIC SIGNS MANUAL. (DETAILS AVAILABLE ON REQUEST).

NOTES

5. DRAINAGE GAPS IN RAISED RIB MARKINGS ARE TO BE PROVIDED IN ACCORDANCE WITH TRAFFIC SIGNS MANUAL CHAPTER 5.
6. SPACING OF RAISED RIBS ON THE DUAL CARRIAGEWAY AND SLIP ROADS ARE TO BE IN ACCORDANCE WITH TRAFFIC SIGNS MANUAL CHAPTER 5.
7. THE WORD "SLOW" TO DIAGRAM 1024 IS TO BE 160mm WHERE SPEED LIMIT IS 40mph OR LESS AND 280mm WHERE THE SPEED LIMIT IS GREATER THAN 40mph.

REV.	DATE	AMENDMENT DETAILS	ORIG	CHK'D	ENG	CAT	APP'D
C1	04/08/15	ISSUE FOR CONSTRUCTION	JE	RT			ACR

Drawn:	Checked:	Approved:	Scale:
JE	RT	ACR	1:1000
Date: 04/08/15	Date: 04/08/15	Date: 04/08/15	Original drawing size: 841 x 594 - A1
Drawing No: A6MARR-2-W-12-004-DR-002	Rev: C1		

Drawn:	Checked:	Approved:	Scale:
JE	RT	ACR	1:1000
Date: 04/08/15	Date: 04/08/15	Date: 04/08/15	Original drawing size: 841 x 594 - A1
Drawing No: A6MARR-2-W-12-004-DR-002	Rev: C1		

CLIENT: CHESHIRE EAST COUNCIL, STOCKPORT METROPOLITAN BOROUGH COUNCIL, MANCHESTER CITY COUNCIL

PROJECT: A6 TO MANCHESTER AIRPORT RELIEF ROAD

TITLE: ROAD MARKINGS WORK SECTION 2 SHEET 2 OF 4

Drawn:	Checked:	Approved:	Scale:
JE	RT	ACR	1:1000
Date: 04/08/15	Date: 04/08/15	Date: 04/08/15	Original drawing size: 841 x 594 - A1
Drawing No: A6MARR-2-W-12-004-DR-002	Rev: C1		